



**AMERICAN SPECIALTIES, INC.**  
441 Saw Mill River Road, Yonkers, NY 10701 (914) 476-9000

MODEL No: 1215

ISSUED: 11-03

REVISED:

**BREAK AWAY SHOWER ROD FLANGE**

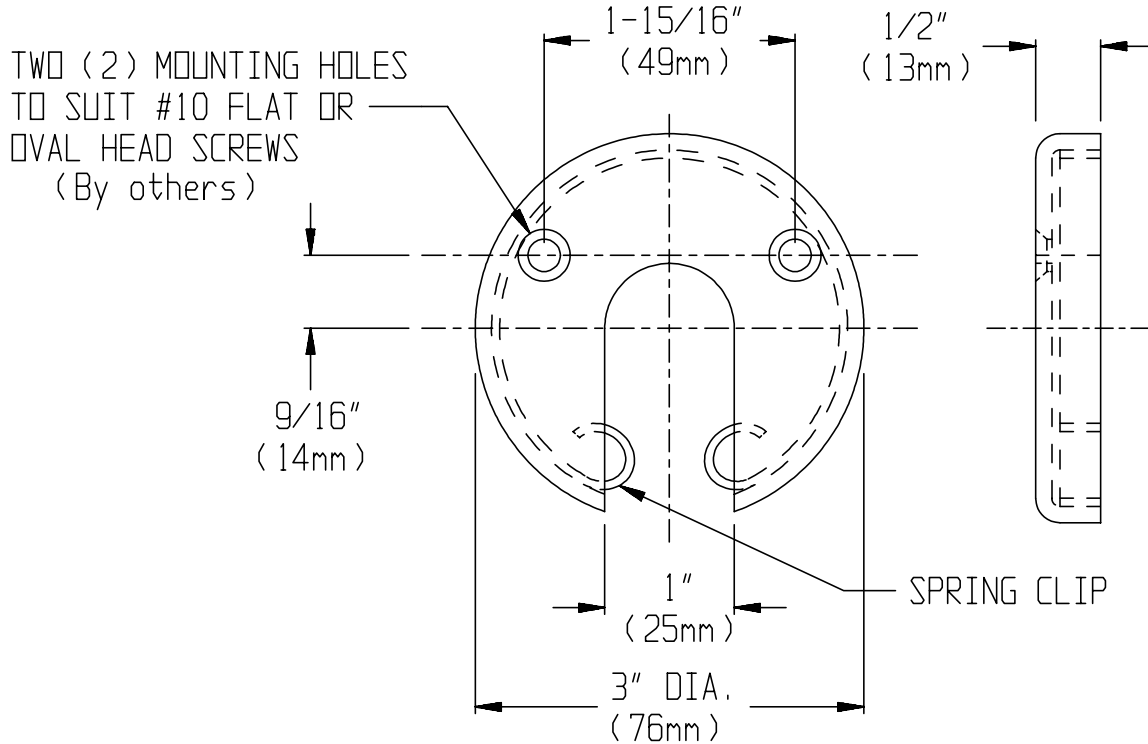

**SPECIFICATION**

Break Away Shower Rod Flange shall be fabricated of alloy 18-8, type 304 stainless steel. Flange shell shall be of drawn seamless construction 1/8" (3mm) thick and shall accommodate a 1" (25mm) outside diameter rod. Captured continuous spring clip holds rod (specified separately) until preset non-adjustable limit is exceeded. Flange cutout shall provide unimpeded drop out of rod when spring clips release rod. Flange shall be provided with two (2) mounting holes to accept N<sup>o</sup> 10 flat or oval head screws. (by others)

**Break Away Shower Rod Flange shall be Model N<sup>o</sup> 1215 as manufactured by American Specialties, Inc., 441 Saw Mill River Road, Yonkers, New York 10701-4913**

**INSTALLATION**

Orient the flanges with the cutout pointing down. Ensure that the spring clip is centered in the opening and that the flanges are in line. Surface mount flanges to wall with two (2) N<sup>o</sup> 10 flat or oval head screws per flange (by others) through mounting holes provided to suit wall conditions. Shower rod (specified separately) should be cut 1/4" to 3/8" (6mm to 10mm) shorter than wall to wall dimension.

**OPERATION**

A 1" (25mm) diameter shower rod is inserted into the flange opening and allowed to rest on the tensioned clips on either side of the flange. If the weight on the rod exceeds the tension pressure of the clips, the rod is released and falls to the floor.

**OPTION**

Different finishes are available and must be specified. Specify optional bright finish or satin finish by adding code suffix "B" or "S" to Model N<sup>o</sup> (e.g. 1215-B or 1215-S).